

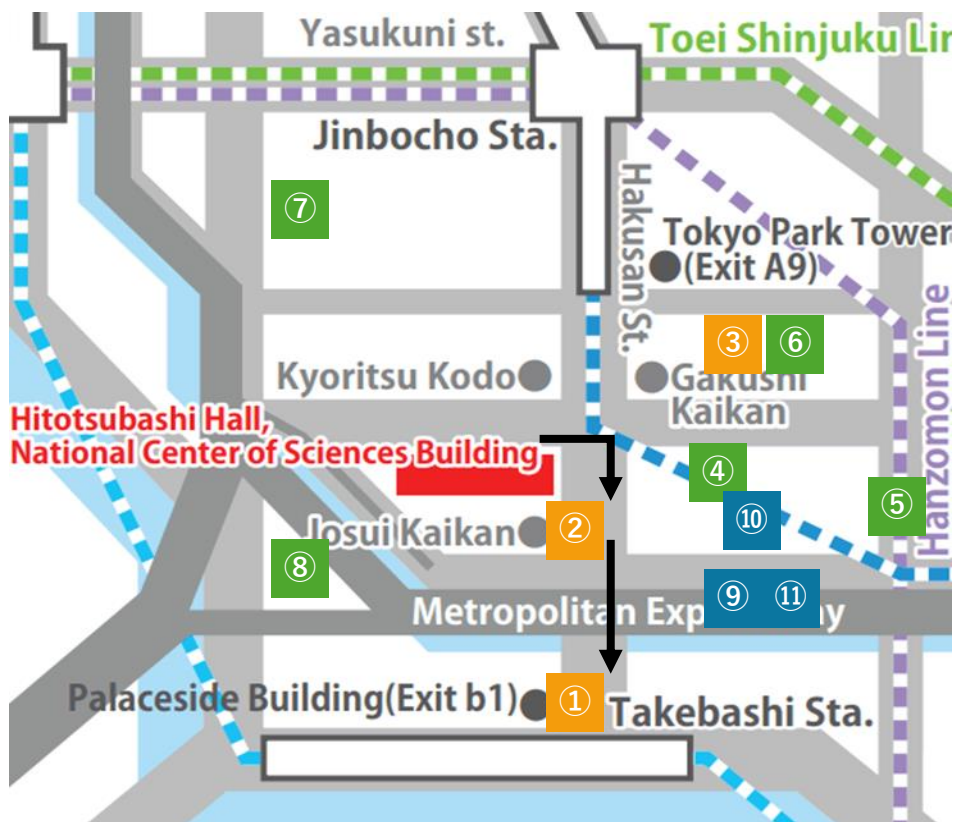



Lunch spot near Hitotsubashi Hall



- ④** MINISTOP
-Convenience stores-
- ⑤** 7-ELEVEN
-Convenience stores-
- ⑥** Family Mart
-Convenience stores-
- ⑦** 7-ELEVEN
-Convenience stores-
- ⑧** 7-ELEVEN
-Convenience stores-
- ⑨** Yude Taro Takebashi
Ten (Soba)
- ⑩** Kin Fukugen
(Chinese)
- ⑪** Unagi Takeya (Unagi)

① PALACESIDE BUILDING (Business Hour may change)		
Restaurant name	Dish	Business Hour
Tea Room Hana	Coffee Shop	
STARBUCKS	Specialty Coffee Store	
KINEYA	Udon	11:00~
Kappogi	Japanese	11:30~14:00
Matumura	Japanese	11:30~
Pub Santrian	Pub Restaurant	11:30~14:30
Cutret Maruya	Tonkatsu	11:00~
Takasago	Curry and Western	11:15~
Marutake	Soba noodles	11:00~
sapana	ASIA	11:00~
New Tokyo	Beer Restaurant	11:30~
1 1 1 (ICHIICHIICHI)	Cafe・French	11:30~14:30
Japon	Ethnic Dining Creation	11:30~
YAKINIKU PALACE B	Yakiniku	11:00~16:00
Akasaka Hanten	Chinese Cuisine	11:00~
okiraku Restaurant	Japanese	11:00~15:00
Teke teke	Japanese	11:00~15:00
ROYAL	Korean cuisine	11:00~
Ichibandori	Japanese	11:30~
Doutor Coffee Shop Takebashi	Café	
Myojinmaru	Japanese	11:30~14:00
Mamma Mia!	Italian cuisine	11:30~

② JOSUI KAIKAN (Business Hour may change)		
Restaurant name	Dish	Business Hour
Jupiter	French	11:30~15:30
Mercury	Café	11:00~
Kyohan Tei	Japanese	11:30~15:00
③ TERRACE SQUARE (Business Hour may change)		
Restaurant name	Dish	Business Hour
NAMASTE INDIA	Indian	11:00~15:00
Jinbocho Sushi Wasabi	Sushi	11:30~15:00
GARB pintino	French	11:30~14:00
Terrace Table	Food Court	11:30~
Menamu no Hotori	Thai	11:30~15:00
Yofuku	Chinese	11:30~15:00
Hakodate Robatayaki Shigezou	Izakaya (Tavern)	11:30~15:00
Nankurunaisa Kibaiyanse Jinbocho Ten	Okinawa cuisine	11:30~15:00
<div> <div> ① Palace Side Building Official website 2D code (Japanese) </div> <div> ② Josui Kaikan Official website 2D code (Japanese) </div> <div> ③ Terrace Square Official website 2D code (Japanese) </div> </div>		
<div>    </div>		

Lunch Venue (Bring in only)

You can use the "conference room 3+4" on the left after exiting the hall venue for only lunch brought from outside.

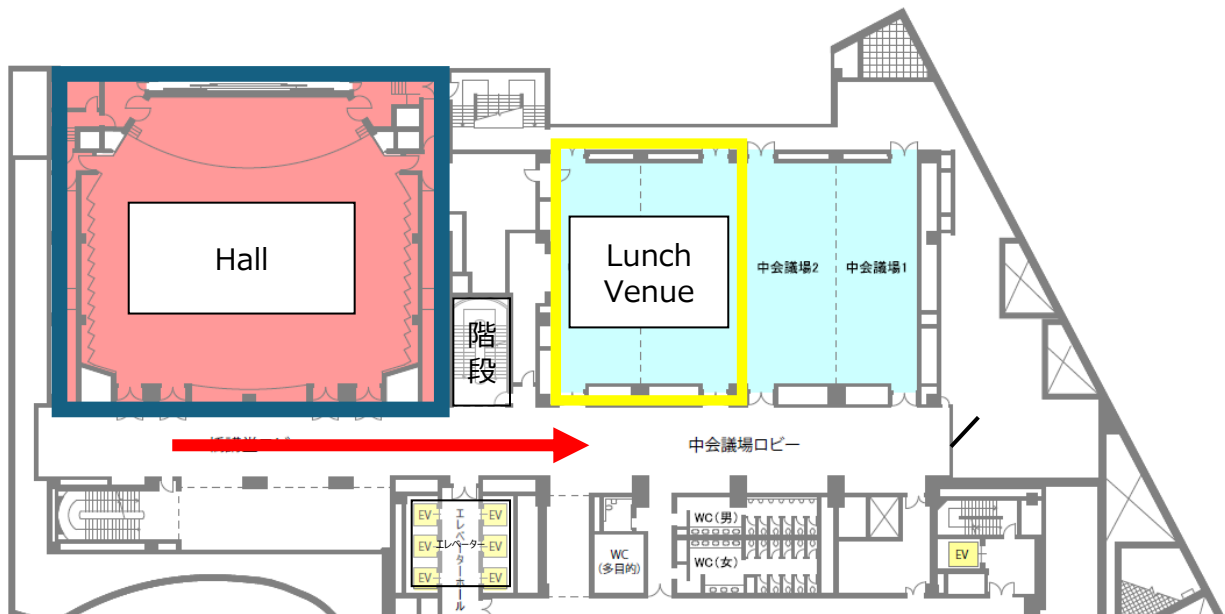

Notes

- Available hours are from 11:55 (after the lunch break begins) to 13:10 (10 minutes before the start of the next session).
- Seating is limited, so please be considerate of others when using the venue. If it is crowded, please consider eating and drinking outside.
- Please note that eating and drinking are prohibited in the hall and lobby.
- Please note that we will not be providing lunch box, microwaves, hot water, chopsticks, etc.
- Please cooperate by separating your trash.